

A UNIT B: GROUND FLOOR

1/8" = 1'-0"

KEY PLAN

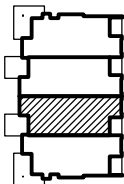

DECK/PORCH AREA:

UNIT B	SF
Ground Floor	315
Second Floor	219
Total:	534

UNIT DESCRIPTION:

BEDROOMS:	3
BATHS:	3
GARAGE:	1-CAR
CREEK-SIDE DECKS:	3
GAS FIREPLACES:	2

AREA:

UNIT B	SF
Ground Floor	1,244
Second Floor	1,282
Total Living Area:	2,526
Garage	349
Gross Area:	2,875

PROJECT:

Island at Rock Creek

LOCATION:

Phase 1 - Building 2  
 Kainu Avenue, Red Lodge, Montana

PREPARED FOR:

Kiely Construction

DATE

26JUN06

REVISION

PDF BROCHURE

DRAWN BY:

WJH

CHECKED BY:

JC

PROJECT NO.

0427

Bldg 2 UNIT B  
 GROUND FLOOR  
 PLAN

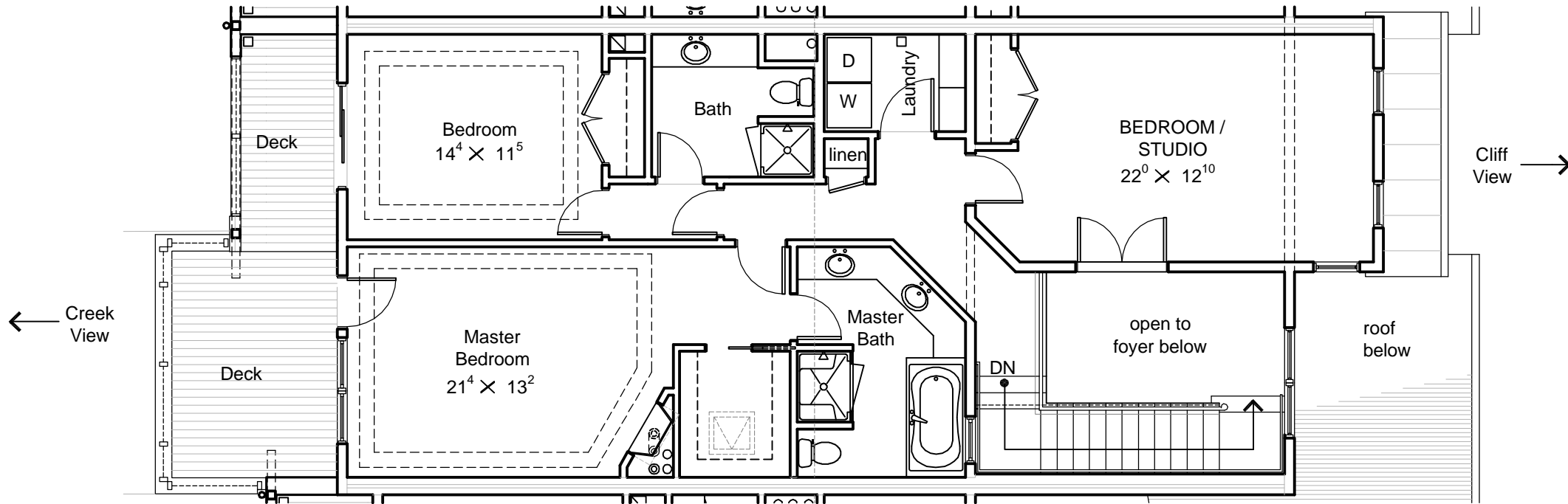

**A UNIT B: SECOND FLOOR**

1/8" = 1'-0"

**KEY PLAN**

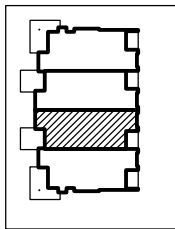

**PROJECT:**  
 Island at Rock Creek

**LOCATION:**  
 Phase 1 - Building 2  
 Kainu Avenue, Red Lodge, Montana

**PREPARED FOR:**  
 Kieley Construction

DATE	REVISION
26JUN06	PDF BROCHURE

**DRAWN BY:** \_\_\_\_\_  
**WJH**  
**CHECKED BY:** \_\_\_\_\_  
**JC**  
**PROJECT NO.**  
 0427

Bldg 2 UNIT B  
 SECOND FLOOR  
 PLAN



**A** CREEK ELEVATION

1/8" = 1'-0"



**B** CLIFF ELEVATION

1/8" = 1'-0"

COPYRIGHT © 2006  
THESE DOCUMENTS, IN PART OR IN WHOLE, AND  
THE DESIGN THEY REPRESENT, ARE THE SOLE  
PROPERTY OF COLLABORATIVE DESIGN  
ARCHITECTS. THESE DOCUMENTS ARE INTENDED  
FOR THE PROJECT ON THE SITE INDICATED. ANY  
USE, REPRODUCTION, MODIFICATION OR  
ADAPTATION WITHOUT THE EXPRESS WRITTEN  
CONSENT OF COLLABORATIVE DESIGN  
ARCHITECTS IS STRICTLY PROHIBITED.

**COLLABORATIVE  
DESIGN  
ARCHITECTS** ON

2280 GRANT ROAD SUITE C • PO BOX 80467 • BILLINGS, MT. 59108-0467  
(406) 248-3443 • FAX (406) 248-3765 • COLLABORATIVE @USADIG.COM

PROJECT: **Island at Rock Creek**

LOCATION:

Phase 1 - Building 2  
Kainu Avenue, Red Lodge, Montana

PREPARED FOR:

Kiely Construction

DATE	REVISION
26JUN06	PDF BROCHURE

DRAWN BY: \_\_\_\_\_  
 WJH  
 CHECKED BY: \_\_\_\_\_  
 JC  
 PROJECT NO. \_\_\_\_\_  
 0427

Bldg 2 UNIT B  
EXTERIOR  
ELEVATIONS